

# RCEPFB ~ Asymmetrische handgefertigte flache Reduzierung M/F ohne Rand

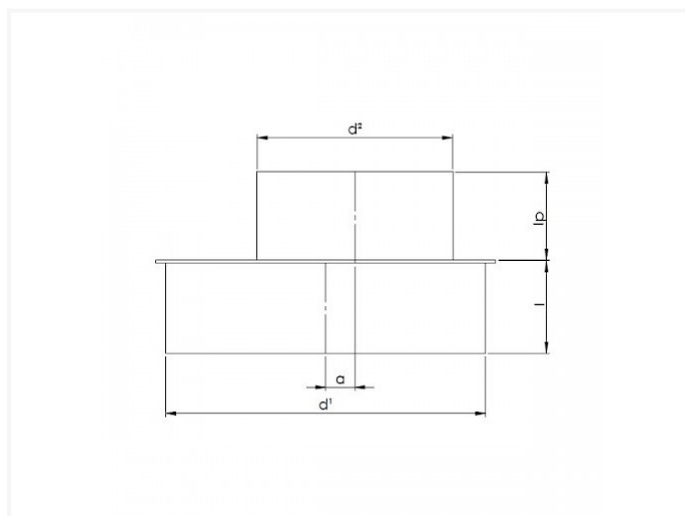

KODE	D1	D2	l	A
RCEPFB 160 100 S	160	100	41.5	10
RCEPFB 200 125 S	200	125	41.5	17
RCEPFB 200 160 S	200	160	41.5	0
RCEPFB 250 125 S	250	125	41.5	42
RCEPFB 250 160 S	250	160	41.5	25
RCEPFB 250 200 S	250	200	41.5	5
RCEPFB 315 125 S	315	125	41.5	75
RCEPFB 315 160 S	315	160	41.5	57
RCEPFB 315 250 S	315	250	41.5	12
RCEPFB 355 200 S	355	200	41.5	57
RCEPFB 355 315 S	355	315	51.5	0
RCEPFB 400 200 S	400	200	41.7	80
RCEPFB 400 250 S	400	250	41.7	55

KODE	D1	D2	I	A
RCEPFB 400 315 S	400	315	51.7	22
RCEPFB 400 355 S	400	355	51.7	2
RCEPFB 500 400 S	500	400	52	30